

IMPRESSIONS

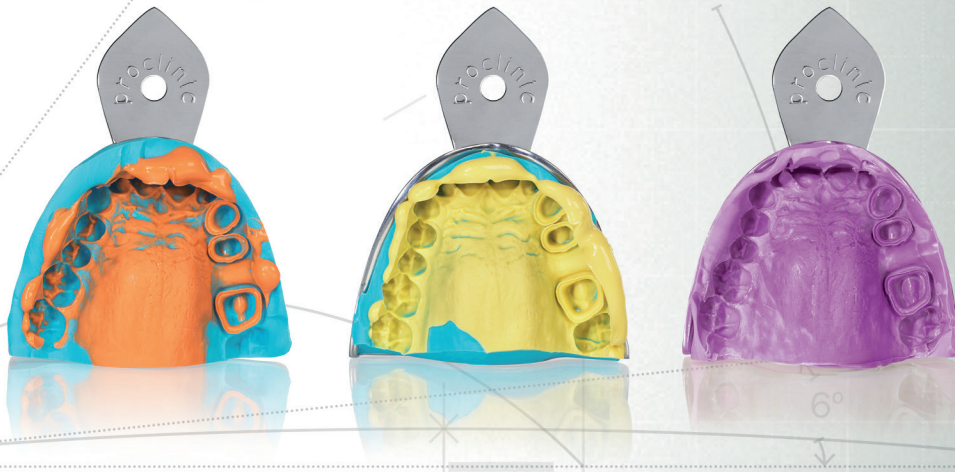

# IMPRESSIVELY EASY AND ACCURATE

For any technique:  
1-step, 2-step and monophasic

A C C U R A C Y A N D Q U A L I T Y

## Proclinc Expert silicones guarantee maximum precision and quality

Nanotechnology and hydrophilic properties combine to provide detailed impressions, guaranteed dimensional precision and total margin integrity.



Excellent reproduction of details

Highly hydrophilic, contact angle <math>< 10^\circ</math>

High elasticity and tear resistance

Versatile, can be used in 1 or 2-step and monophasic techniques

Perfect thixotropy, no bubbles or drips



**Dr. Alexander Johansson**  
Clínica ZahnCity GmbH, Zurich, Switzerland  
[www.zahncity.ch](http://www.zahncity.ch)

"I had not tried an ultralight silicone before and I have found that Proclinic Expert Ultra Light Body silicone is better than the light body silicone I usually use."



**Proclinic Expert**  
silicones are  
recommended by  
professionals:

**Dr. Carlos Gargallo**  
Clínica Carlos Gargallo,  
Barcelona, Spain  
Member of Association of Dental  
Surgeons number 3947

"The Proclinic Expert range of silicones provides very satisfactory results in all customary impression techniques. Both the normal and ultra-light products offer a very high degree of precision and consistency and are easy to handle; they are ideal for fixed dentures, invisible braces and rebases. After a double impression, manual silicone putties and automatic mix putties can be trimmed easily with a scalpel."

**Dr. Eduardo González Arroyo**  
Clínica Fernández, Ibiza, Spain  
[www.oralsturgerytube.com](http://www.oralsturgerytube.com)  
Member of Association of Dental  
Surgeons number 28007247

"These new silicones are better quality than the previous generation of Proclinic silicones which I always used in the past."



# Proclinc Expert silicones allow impressions to be taken quickly and easily

Modulated times and different viscosities for each and every clinical need.

Details reproduced accurately.

Highly hydrophilic, minimising the risk of pores. Ensure highly accurate impressions by using Proclinc Expert silicones.

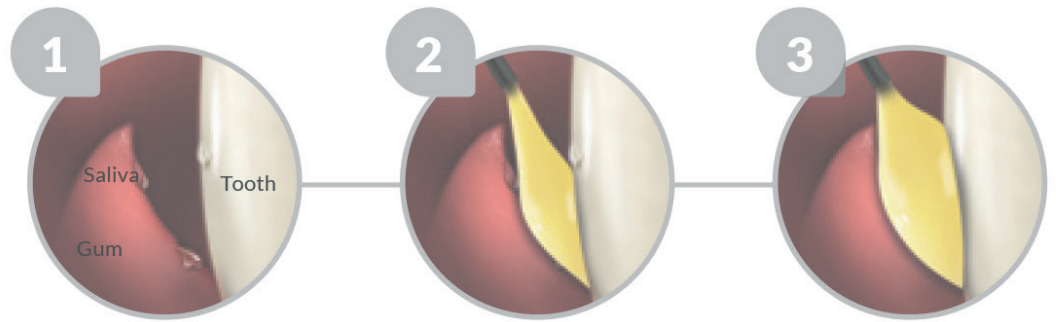

| *Times at 23° C                        | Ultra Light Body         | Light Body               | Light Body               | Regular Body              | 380 Heavy Body           | 380 Heavy Body           | 380 Putty Soft     | Putty Soft        | Putty Soft        |
|--|--------------------------|--------------------------|--------------------------|---------------------------|--------------------------|--------------------------|--------------------|-------------------|-------------------|
|  | Fast Set                 | Regular Set              | Fast Set                 | Regular Set               | Regular Set              | Fast Set                 | Fast Set           | Regular Set       | Fast Set          |
| Reorder                                | 15156                    | 15153                    | 15154                    | 15152                     | 15158                    | 15159                    | 15157              | 15150             | 15151             |
| ISO 4823                               | Type 3                   | Type 3                   | Type 3                   | Type 2                    | Type 1                   | Type 1                   | Type 0             | Type 0            | Type 0            |
| ADA 19                                 | Light-bodied Consistency | Light-bodied Consistency | Light-bodied Consistency | Medium-bodied Consistency | Heavy-bodied Consistency | Heavy-bodied Consistency | Putty Consistency  | Putty Consistency | Putty Consistency |
| Mix                                    | 1:1                      | 1:1                      | 1:1                      | 1:1                       | 5:1                      | 5:1                      | 5:1                | 1:1               | 1:1               |
| System                                 |                          |                          |                          |                           |                          |                          |                    |                   |                   |
| Mix type                               | Auto mixing system       | Auto mixing system       | Auto mixing system       | Auto mixing system        | Auto mixing system       | Auto mixing system       | Auto mixing system | Hand mixing       | Hand mixing       |
| Total working time                     | 1'30"                    | 2'                       | 1'30"                    | 2'                        | 2'                       | 1'30"                    | 1'30"              | 2'                | 1'30"             |
| Minimum time in patient's mouth        | 2'30"                    | 3'30"                    | 2'30"                    | 3'30"                     | 3'30"                    | 2'30"                    | 2'30"              | 3'30"             | 2'30"             |
| Curing time*                           | 4'                       | 5'30"                    | 4'                       | 5'30"                     | 5'30"                    | 4'                       | 4'                 | 5'30"             | 4'                |
| Deformation under pressure (min - max) | 3 - 5%                   | 3 - 5%                   | 3 - 5%                   | 3 - 5%                    | 3 - 5%                   | 3 - 5%                   | 1 - 3%             | 1 - 3%            | 1 - 3%            |
| Elastic memory                         | > 99,5%                  | > 99,5%                  | > 99,5%                  | > 99,5%                   | > 99,5%                  | > 99,5%                  | > 99%              | > 99%             | > 99%             |
| 24-hour linear dimensional change      | < 0,20%                  | < 0,20%                  | < 0,20%                  | < 0,20%                   | < 0,20%                  | < 0,20%                  | < 0,20%            | < 0,20%           | < 0,20%           |
| Shore A hardness scale                 | 45±2                     | 45±2                     | 45±2                     | 45±2                      | 60±2                     | 60±2                     | 60±2               | 60±2              | 60±2              |
| Suggested techniques                   | 2-step                   | 1-step, 2-step           | 1-step, 2-step           | 1-step, 2-step            | 1-step, 2-step           | 1-step, 2-step           | 1-step, 2-step     | 1-step, 2-step    | 1-step, 2-step    |
|  |                          |                          |                          |                           |                          |                          |                    |                   |                   |
|  | LOW CONSISTENCY          |                          |                          |                           | HIGH CONSISTENCY         |                          |                    |                   |                   |

Complete your range of bite registration silicones with Proclinc Expert silicone. Shore A hardness 95 (15160) guarantees excellent reproduction of details.

# Proclinic Expert silicones can be adapted to all impression techniques

## 1-STEP TECHNIQUE

|                        |                       |                                |
|------------------------|-----------------------|--------------------------------|
| <b>PUTTY SOFT FAST</b> | Working time<br>1'30" | Minimum time in mouth<br>2'30" |
| <b>LIGHT BODY FAST</b> | Working time<br>1'30" | Minimum time in mouth<br>2'30" |

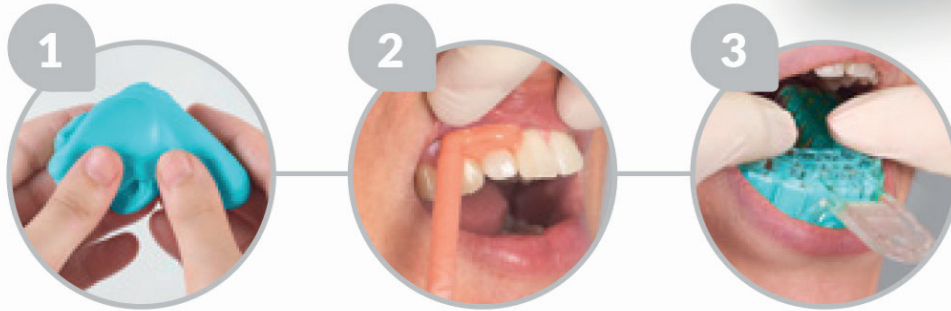

## 2-STEP TECHNIQUE

|                           |                       |                                |
|---------------------------|-----------------------|--------------------------------|
| <b>PUTTY SOFT REGULAR</b> | Working time<br>2'    | Minimum time in mouth<br>3'30" |
| <b>ULTRA LIGHT BODY</b>   | Working time<br>1'30" | Minimum time in mouth<br>2'30" |

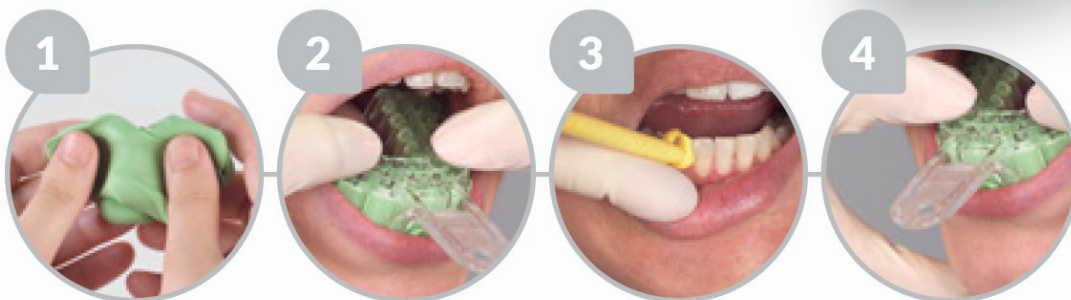
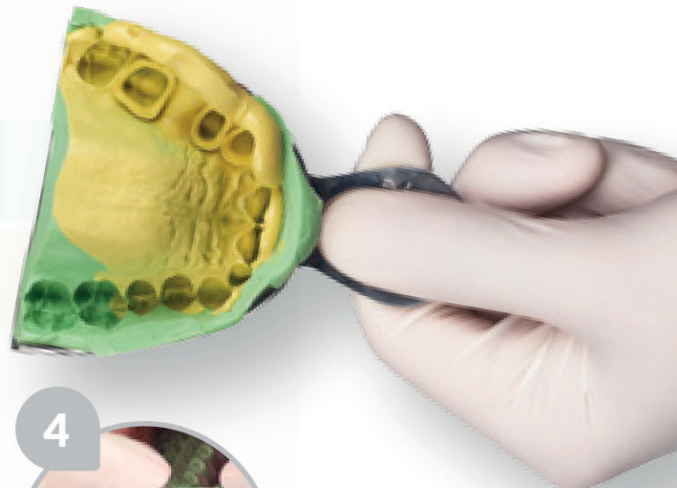

# Proclinic Expert silicones guarantee outstanding results in clinical testing

**THE DENTAL ADVISOR**  
Improving Patient Care Through Research & Education

Proclinic Expert VPS  
Impression Material  
++++½

THE DENTAL ADVISOR  
www.dentaladvisor.com

RATINGS:  
Excellent +++++  
Very Good ++++-  
Good +++

**373**  
APPLICATIONS

**87%**

of dentists rate Proclinic  
Expert silicones  
**AS GOOD AS  
OR BETTER**  
than their usual silicone

**91%**

SATISFACTION

**78%**

RECOMMENDATION



| [www.proclinic-products.com](http://www.proclinic-products.com) |

[info@proclinic-products.com](mailto:info@proclinic-products.com) |

