

E14(ED14/ES14)

Instrument for the removal of broken files inside the root canal. The length of tip slender part is (22mm).

If possible place the patient's head in a position where the root canal is horizontal with a downward inclination. Rotate the tip of the instrument counterclockwise around the broken part until it is picked out from the root canal.

To avoid push the broken file deeper into the root canal, do not use pressure to the instrument in the axial direction.

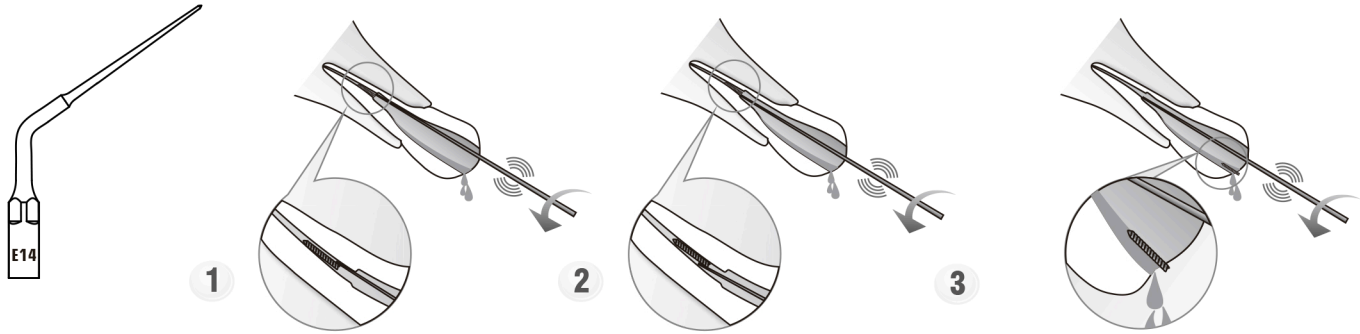

Demo Video

MODE: E

POWER

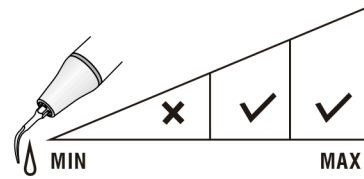
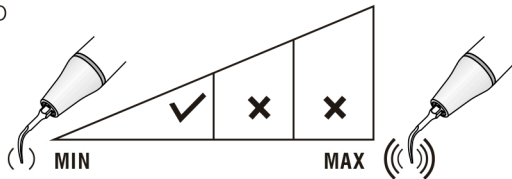

IRRIGATION