

E1 (ED1/ES1)

120° holder, used to hold the file diameter $\Phi 0.7\text{mm}$ or $\Phi 0.8\text{mm}$.

Recommended for the cleaning and irrigating of the root canal, usually used for the anterior teeth.

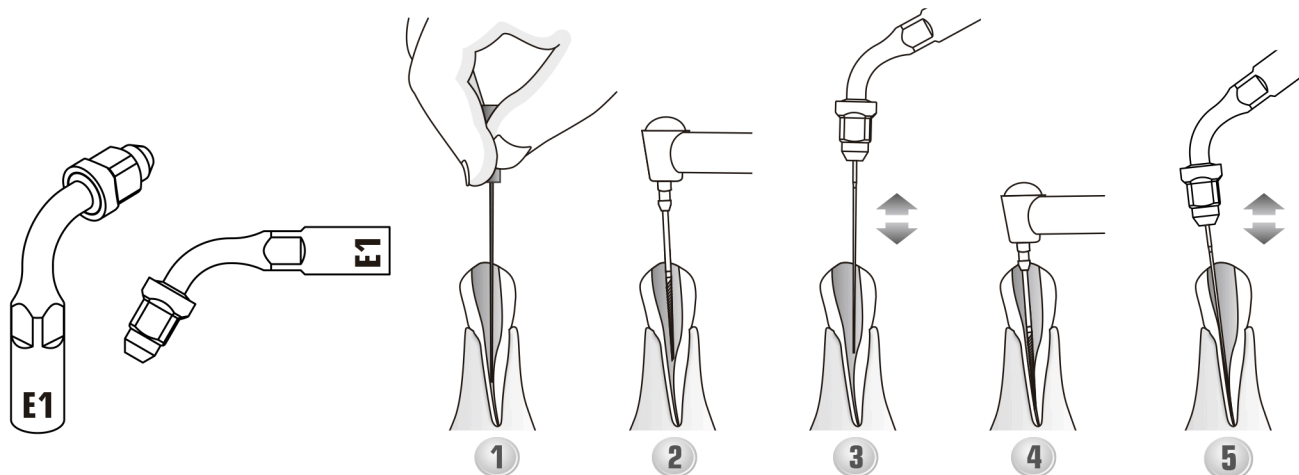

Demo Video

Use only the provided flat wrench to tighten the file holders on the handpiece, as well as for gently tightening the files or instruments in the holder. Do not over tighten.

Do not tighten the holder nut when no file or instrument is installed as this may damage it.

Do not mix-install the holder with $\Phi 0.7\text{mm}$ and $\Phi 0.8\text{mm}$ file, the $\Phi 0.8\text{mm}$ file will not be able to be installed after a $\Phi 0.7\text{mm}$ file installed on the holder. Each Endo file is recommended to be used not more than 10 times.

MODE: E
POWER

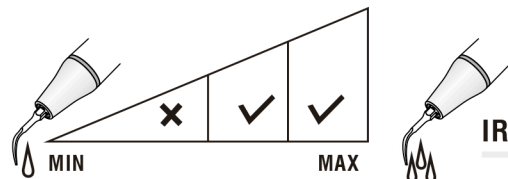
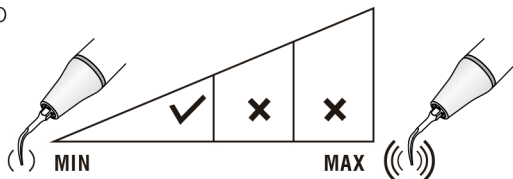

IRRIGATION