

Data sheet for suction terminal

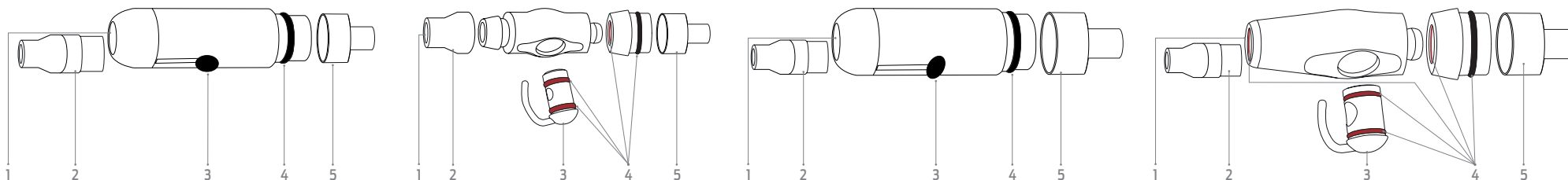

Suction terminal code	Compatibility	Material	Weight (gr)	1	2	3	4	5		
				cannula Ø insertion	Can be equipped with saliva ejector adaptor Ø 6,5 mm	Saliva ejector adaptor code	Suction terminal lever code	O-ring code	Ø Tube terminal adaptor	Tube terminal adaptor code
VC1602/P	Cattani®	PVC	17	11 mm	●	040T515 (Opt)	2T5238	OR1602/P	I 10,8 mm	
VC1604P	Cattani®	Aluminium	29	6,5 mm	●	040T515.1	121T9300	OR1604P (Kit of 4 pc.)	Quick connector	Ø 16 mm
VC1604PC	Isodent®/ Castellini®		43						I 10,2 mm	TCM0014
VC1604PE	Eurodent®		38						I 8,4 mm	1234254
VC1604PK	Kavo®		44						I 8,4 mm	TCM0010
VC1604PP	Plameca®		56						I 10,5 mm	TCM0011
VC1604PS	Sirona®		41						I 8,4 mm	1234253
VC1604PD	Dci®		32						I 3/16"	
VC1602/G	Cattani®		PVC						27	11-16 mm
VC1604G	Cattani®	Aluminium	61	11 mm	●	040T515 (Opt)	111T7400	OR1604G (Kit of 5 pc.)	Quick connector	Ø 22 mm
VC1604GC	Isodent®/ Castellini®		84						I 17,2 mm	TCM0013
VC1604GE	Eurodent®		72						I 14,7 mm	1234252
VC1604GK	Kavo®		89						I 20 mm	1234255
VC1604GP	Plameca®		78						I 17,2 mm	TCM0012
VC1604GS	Sirona®		76						I 14,7 mm	1234251
VC1604GD	Dci®		63						I 1/2"	

Small suction terminal connection table



Large suction terminal connection table

